

WASP Tomahawk Band Clamp Instructions

The clamps can be fitted to either the badged or non-badged side of the frame to suit left or right hand hold. Remember you must always pull the bands over the tops of the fork tips.

To set the band clamps for OTT shooting



Position the clamp plate with the clamp bar inside of the band groove on the frame.

Insert the M5 screw through the hole in the frame and screw in a couple of turns into the clamp.

When fitting your band set, insert the band under the clamp ensuring that the band goes through the band groove & up to the screw. When the clamp plate is tightened the end of your band set should be fully under the clamping bar as the photograph below.



The clamping screws need only a firm nip to secure the band set. It is not necessary to over tighten the screw.

All that is left is to enjoy owning your Wasp Slingshot & always remember to shoot safely and wear your safety glasses.

Read Before Using Your Slingshot

Cleaning The Frame. Use luke warm water with a mild soap; which is ideal for wiping down the frame then dry with a cloth or paper towelling. This is all that is required to clean the frame. **DO NOT** use any kind of solvents or aggressive cleaning substances.

DO NOT DRY USING A HEAT SOURCE. DO NOT MODIFY THE FRAME IN ANY WAY.

Keep Frame away from oils, solvents, glues, polishes, heat sources and extreme freezing conditions do not store in direct sunlight. (Remember to Store the Slingshot away from Children and minors).

Damage to Frame. If you suspect that there is possibility of damage to the frame due to a Fork Hit or other impact source, fully inspect the Frame and **DO NOT SHOOT** until you are totally satisfied that the frame has full integrity. Nicks, Cuts, Bruises & Burrs to the Frame must be treated to the same manner of detailed inspection. Check the condition of Bands, Tubes and the pouch for damage or wear before each shot. If in doubt Throw it away! Slingshots can cause severe personal injury or death!

REMEMBER ALWAYS Wear Safety Glasses for EYE Protection. Slingshots, Ammo, and Band breakage are Dangerous to your Eyes. **DO NOT ATTEMPT TO USE** this frame without fully understanding the safety requirements and techniques required to shoot safely. Ensure you use an adequate ammo catch box or back stop before you shoot. Be aware of your location and surroundings when shooting - Are they SAFE! **DO NOT** shoot at hard solid surfaces or water; rebounds and ricochets are equally dangerous.

Liability Disclaimer

Slingshots are NOT a Toy! You agree that upon purchase or use that the Designer, Manufacturer and Retailer, shall NOT be held responsible or liable for any consequential, direct or indirect or special loss, injury or accidents caused by the Slingshot Frame, Bands or Ammo or any other related items that are purchased. In ALL cases YOU the Purchaser or the USER assumes full responsibility and all risk associated with the use of our products. Our products are NOT to be purchased by anyone under the age of 18 and must only be used by people under the age of 18 with responsible adult supervision. It is the user's responsibility to be compliant and to conform to local laws regarding Slingshots and related products.

Slingshots can be dangerous!
Understand that if you use this slingshot you do so totally at your own risk.



www.waspslingshots.co.uk

TOMAHAWK
www.waspslingshots.co.uk



Please Read All Of This User Notice Before Using Your Slingshot

Ensure when using the Slingshot that the Bands are pulled OVER the Fork Tips!



SHOOT SAFE! Shoot Responsibly.
YOU MUST ALWAYS WEAR SAFETY GLASSES WHEN USING THE SLINGSHOT

Make sure you are compliant and conform to local laws regarding Slingshots and related products.

contact@waspslingshots.co.uk
www.waspslingshots.co.uk

WASP Enzo Band Clamps

Fit the Tomahawk Frame

Available at www.waspslingshots.co.uk

Contents

- 2 x Band Clamp Plates
- 2 x M5 Machine screws
- 1 x Allen Key

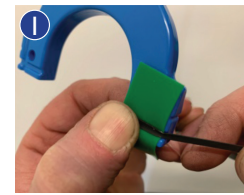

Place your band 12-20mm over the back of the slingshot (target side) and begin wrapping.

Make sure it's tight enough to ensure that the band will not work loose whilst shooting but do not pull so tight that it's impossible to hold in place.

Apply two or three wraps, stretching the tie in material as you wrap. Again, stretch it tight, but don't over or under-do it.

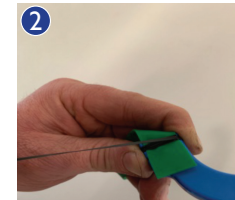

Fold the excess band material back over your wraps & wrap another two times. Always keeping the wrap material tight.

Place a looped piece of string or similar on the target side of the folded wrap and make another TWO more tensioned wraps.

These wraps lock in the end, so keep them neat and tight to hold the band securely.

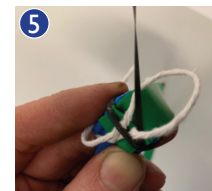

Carefully holding the tensioned wraps in place, feed the end of the wrap material through the loop.

Don't lose the tension or you return to the start of these instructions.

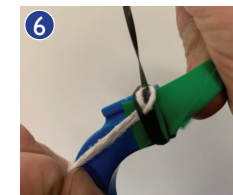

Pull the loop material back underneath the final two wraps. If you have a long piece of wrap material over-hanging you can always trim it back with a sharp pair of scissors.

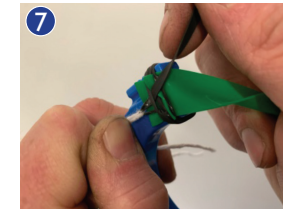

Remember that these instructions are a guideline of how to tie your bands.

It can be quite tricky to begin with but as with most things the more you try the better at it you will become.



Now repeat for your second fork tip checking that your pouch is in line with the bands i.e. not twisted and your then good to go.

All that is left is to enjoy owning your Wasp Slingshot & always remember to shoot safely and wear your safety glasses.

Further information & Instructional Videos on how to band your slingshot are viewable on our website.

www.waspslingshots.co.uk/guides